

MASTER PLAN

FLOOR PLANS

RESIDENTIAL UNIT PLANS

THE
CREST

LOCATION IN THE MASTER PLAN

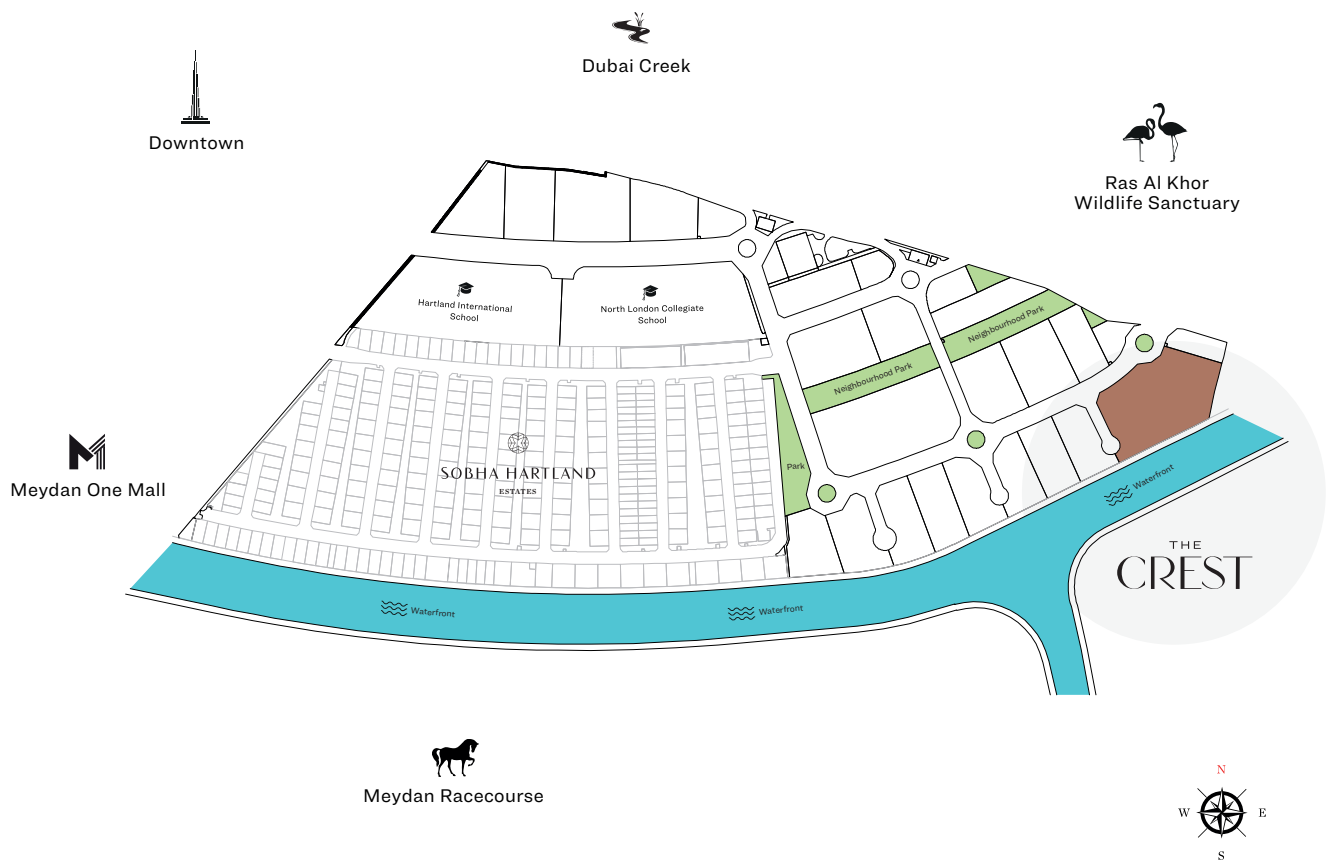

APARTMENT FEATURES



Landmark views



Covered car parking



Fully fitted kitchens



Bedroom wardrobe in all units

FLOOR PLAN LAYOUT

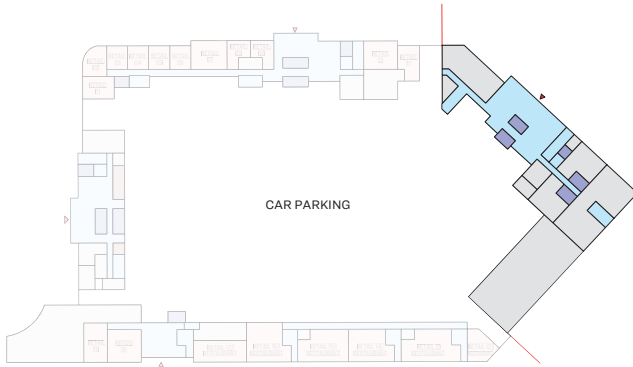
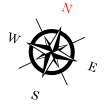

GROUND LEVEL

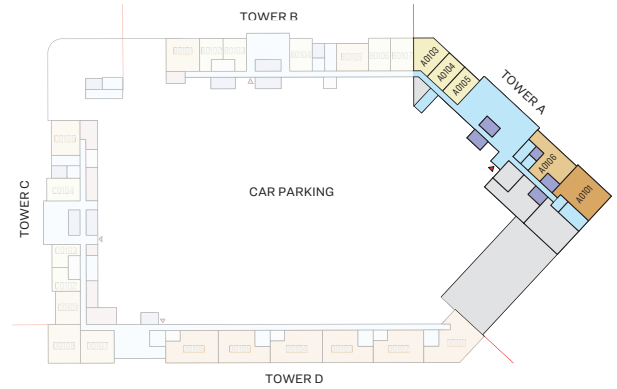

LEVEL-01(PODIUM 01)

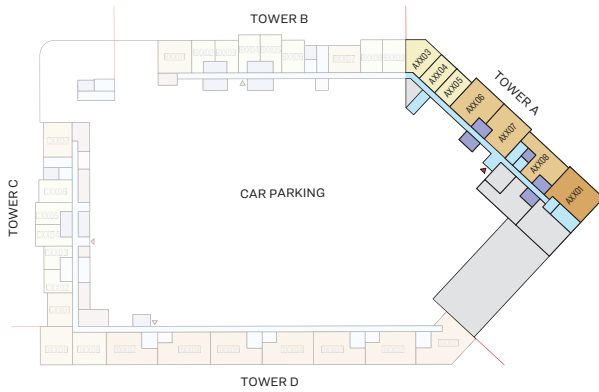

LEVEL-02,03 (PODIUM 02,03) TYPICAL FLOOR PLAN

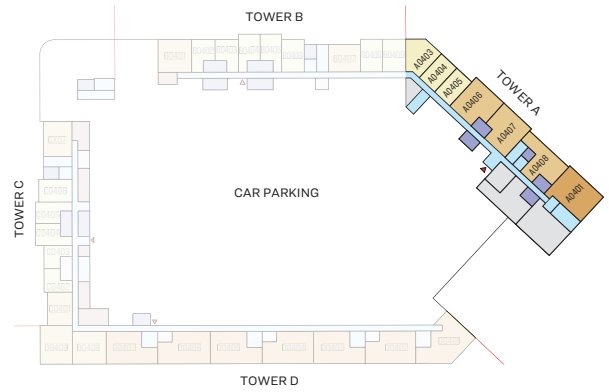

LEVEL-04(PODIUM 04)

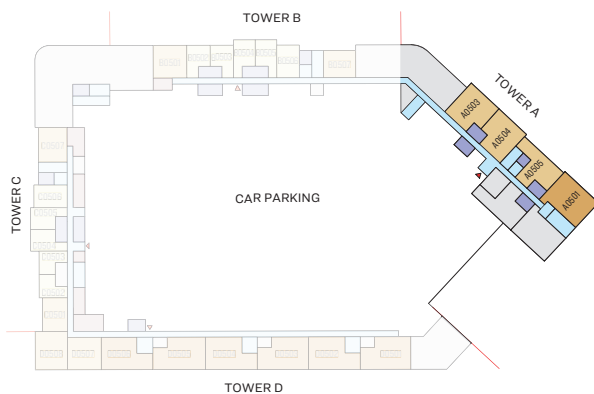

LEVEL-05(PODIUM 05)

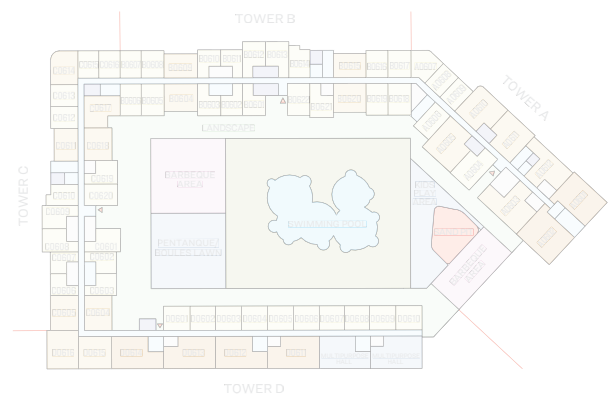

LEVEL-06

- | | | | |
|---|---|--|---|
| 1 BED UNIT | SERVICES | COMMERCIAL | BARBEQUE AREA |
| 2 BED UNIT | LIFT | LANDSCAPE | SWIMMING POOL DECK |
| 3 BED UNIT | AMENITIES | SWIMMING POOL | |
| LOBBIES,CORRIDORS & STAIRS | APARTMENT STORE | SAND PIT | |

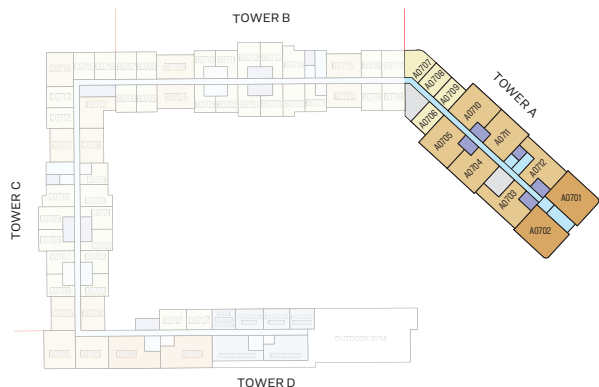

LEVEL-07

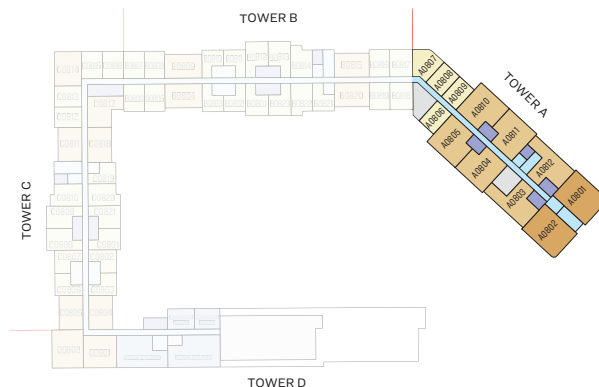

LEVEL-08

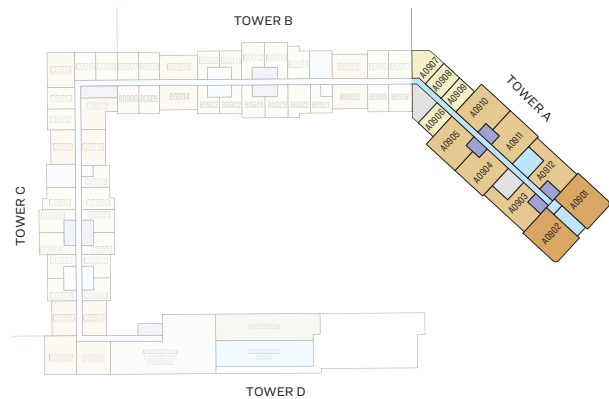

LEVEL-09

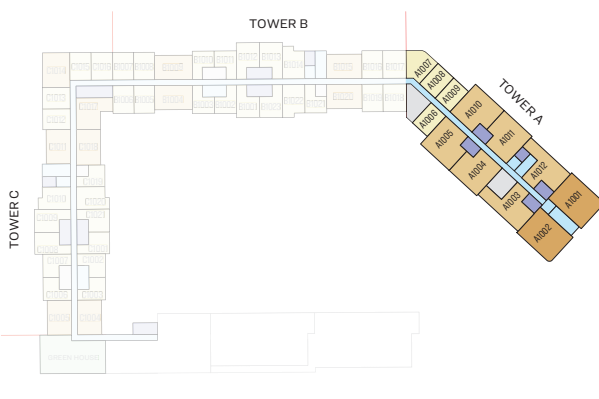

LEVEL 10

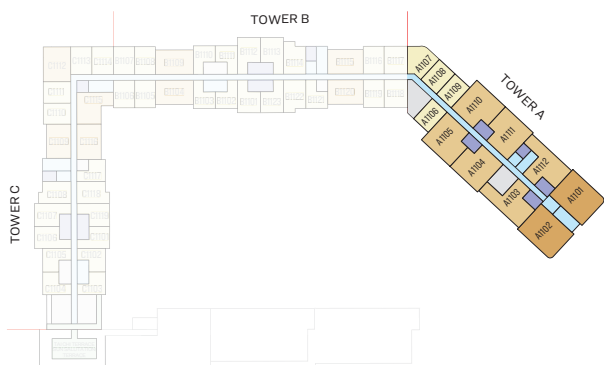

LEVEL 11

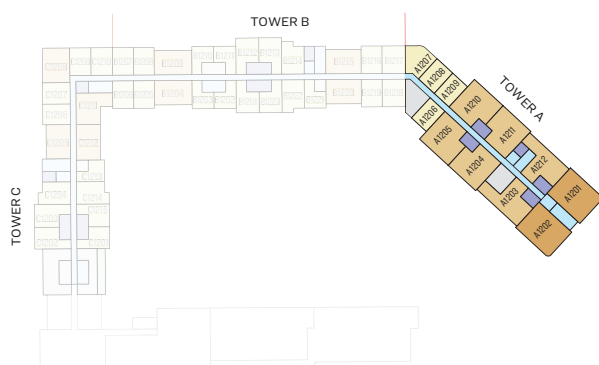

LEVEL 12

- | | | |
|---|--|---|
| 1 BED UNIT | SERVICES | SWIMMING POOL |
| 2 BED UNIT | LIFT | SWIMMING POOL DECK |
| 3 BED UNIT | AMENITIES | |
| LOBBIES,CORRIDORS & STAIRS | LANDSCAPE | |

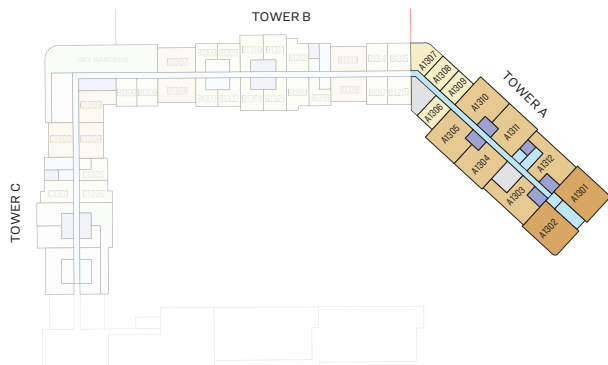

LEVEL 13

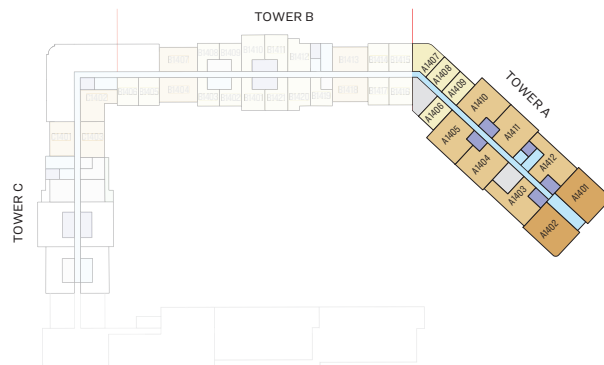

LEVEL 14

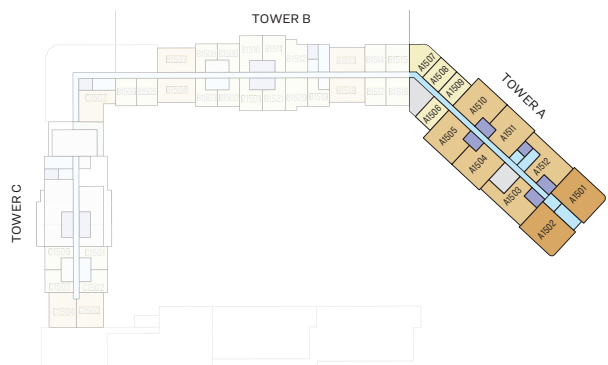

LEVEL 15

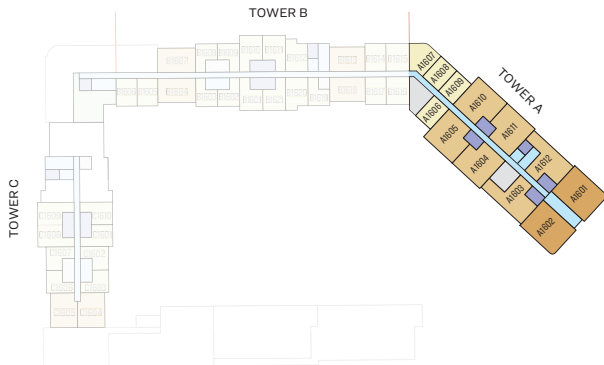

LEVEL 16

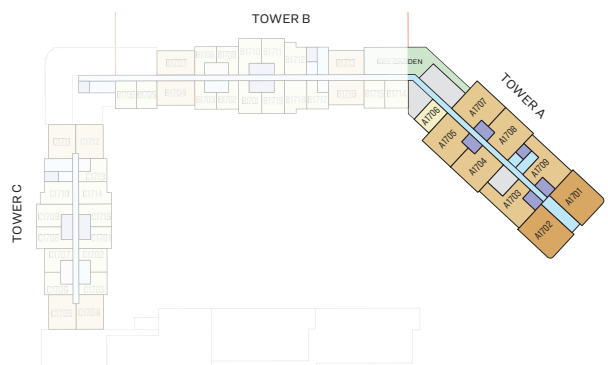

LEVEL 17

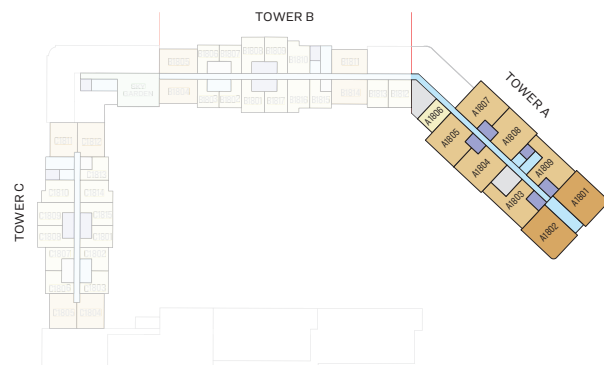

LEVEL 18

- | | |
|---|---|
| 1 BED UNIT | SERVICES |
| 2 BED UNIT | LIFT |
| 3 BED UNIT | AMENITIES |
| LOBBIES, CORRIDORS & STAIRS | LANDSCAPE |

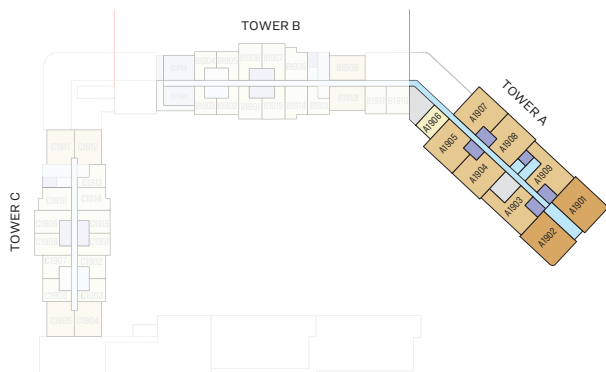

LEVEL 19

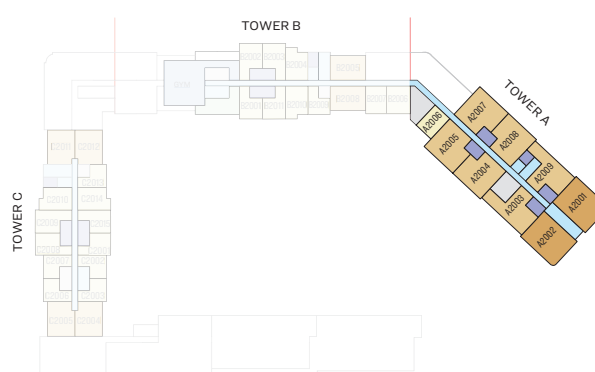

LEVEL 20

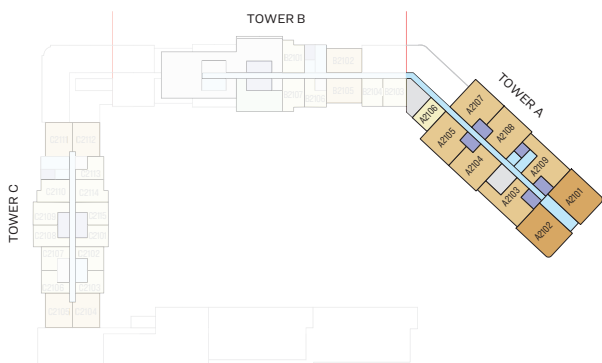

LEVEL 21

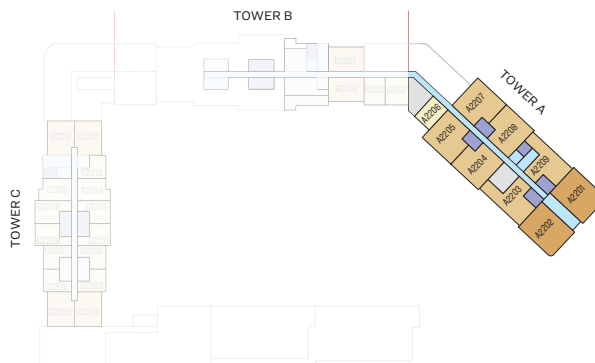

LEVEL 22

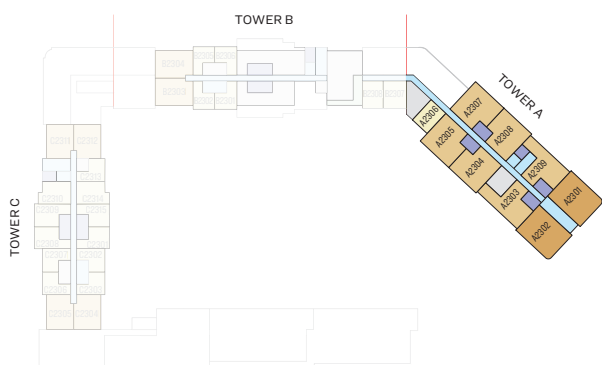

LEVEL 23

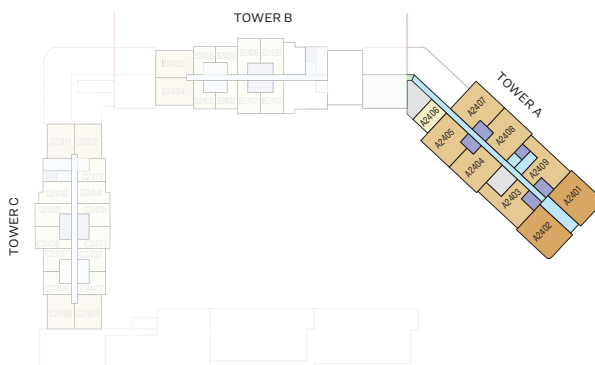

LEVEL 24

- | | |
|--|--|
| 1 BED UNIT | SERVICES |
| 2 BED UNIT | LIFT |
| 3 BED UNIT | AMENITIES |
| LOBBIES, CORRIDORS & STAIRS | LANDSCAPE |

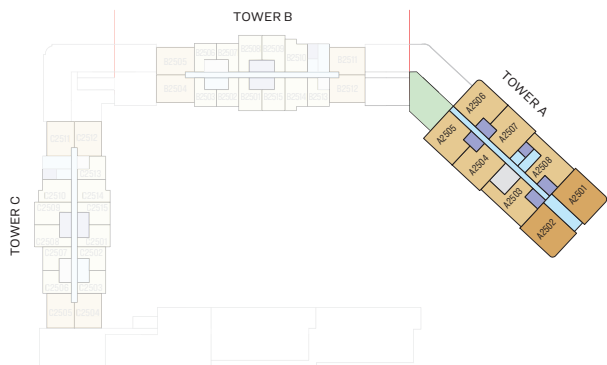

LEVEL 25

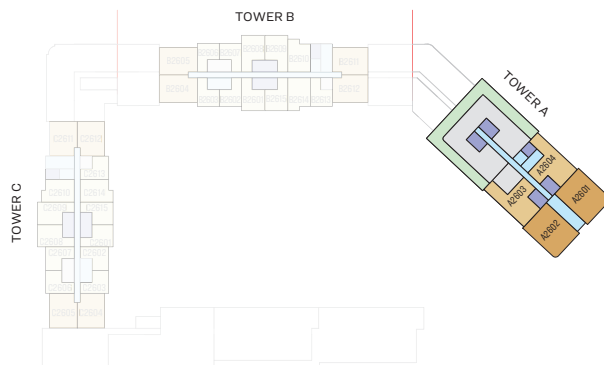

LEVEL 26

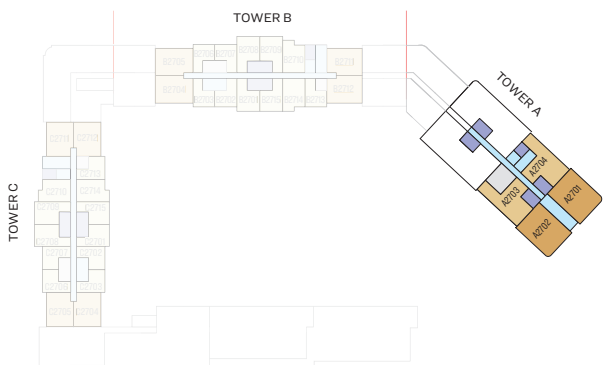

LEVEL 27

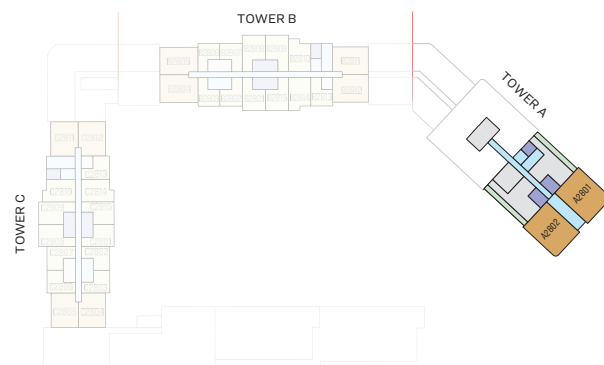

LEVEL 28

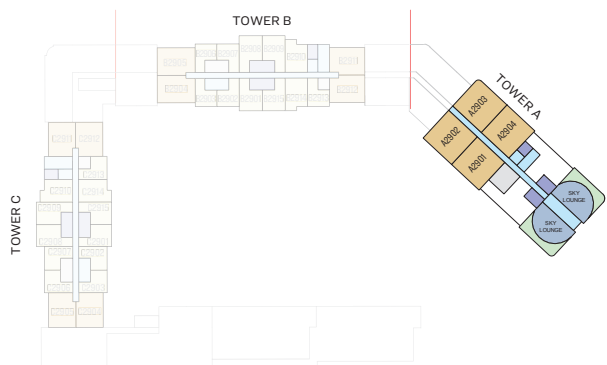

LEVEL 29

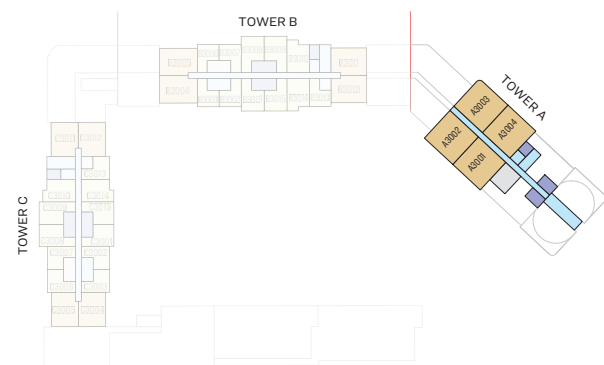

LEVEL 30

- | | |
|--|--|
| 1 BED UNIT | SERVICES |
| 2 BED UNIT | LIFT |
| 3 BED UNIT | AMENITIES |
| LOBBIES, CORRIDORS & STAIRS | LANDSCAPE |

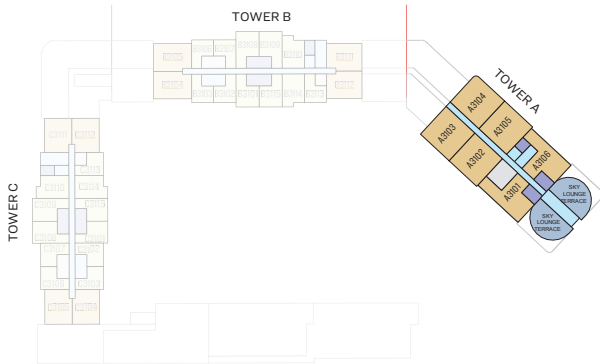
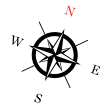

LEVEL 31

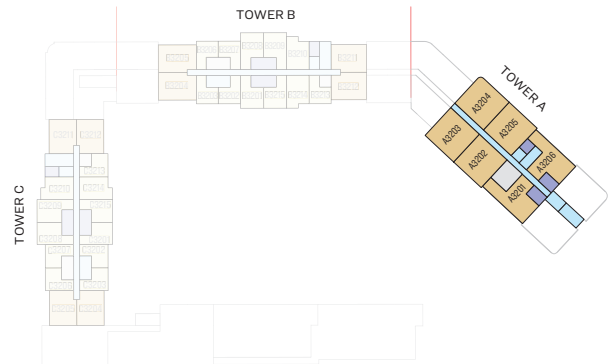

LEVEL 32

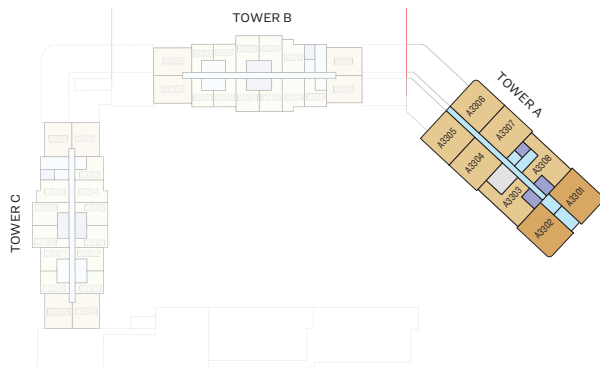

LEVEL 33

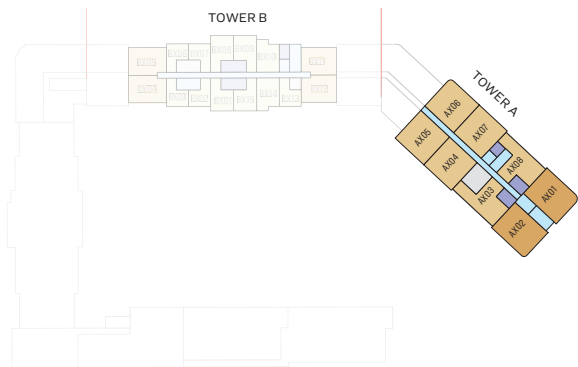

LEVEL 34,35,36,37,38
TYPICAL FLOOR PLAN

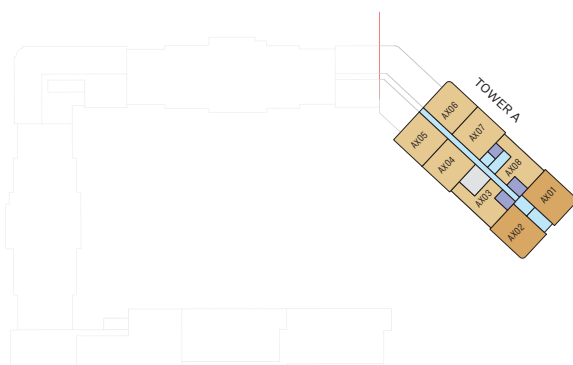

LEVEL 39,40,41,42,43,44,45,46
TYPICAL FLOOR PLAN

- | | |
|--|--|
| 1 BED UNIT | SERVICES |
| 2 BED UNIT | LIFT |
| 3 BED UNIT | AMENITIES |
| LOBBIES, CORRIDORS & STAIRS | |

RESIDENTIAL UNITS

THE
CREST

1 BEDROOM APARTMENT

TYPE A (with powder room + balcony)

TOTAL SALEABLE AREA

SUITE = 528.83 SQ.FT.
 BALCONY = 44.24 SQ.FT.
 TOTAL = 573.07 SQ.FT.

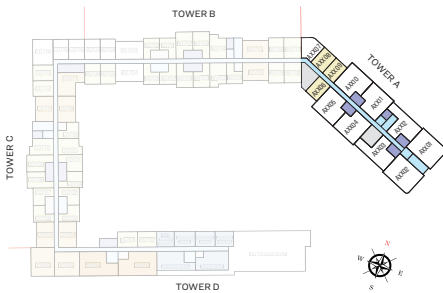

LEVEL 07-16 & 17-24

UNIT

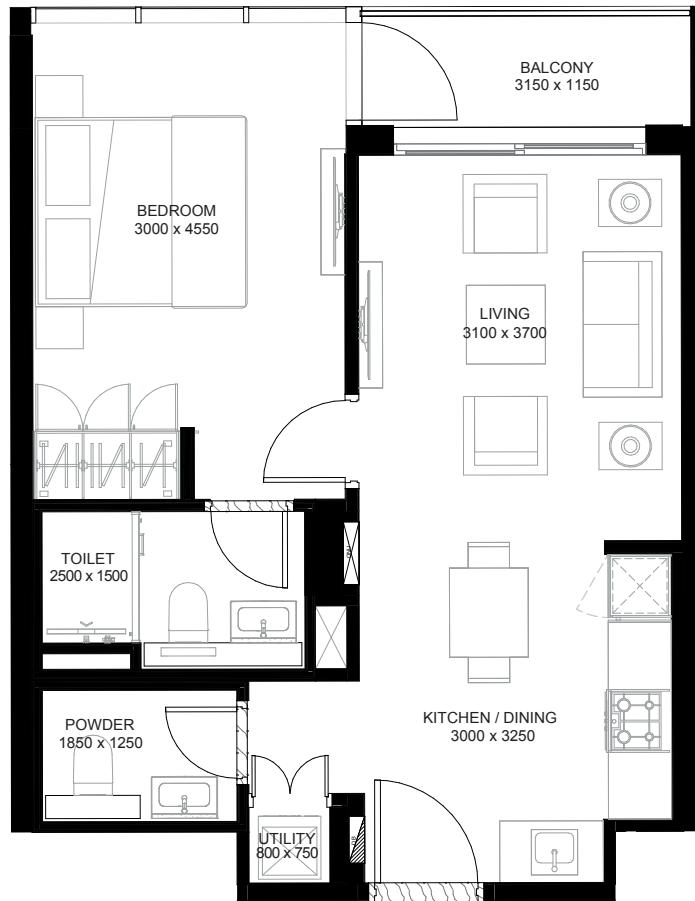

List of unit numbers with this unit plan:

VIEWS

Amenities

A0706, A0806, A0906, A1006, A1106

Amenities, Waterfront

A1206, A1306, A1406, A1506, A1606, A1706, A1806, A1906, A2006, A2106, A2206, A2306, A2406

Downtown, Sports Court, Ras Al Khor

A0708*, A0709*, A0808*, A0809*, A0908*, A0909*, A1008*, A1009*, A1108*, A1109*, A1208*, A1209*, A1308*, A1309*, A1408*, A1409*, A1508*, A1509*, A1608*, A1609*

* These apartments have mirrored units plans of the above

1 BEDROOM APARTMENT

TYPE A1 (with powder room + balcony)

TOTAL SALEABLE AREA

SUITE = 568.73 SQ.FT.
 BALCONY = 122.22 SQ.FT.
 TOTAL = 690.96 SQ.FT.

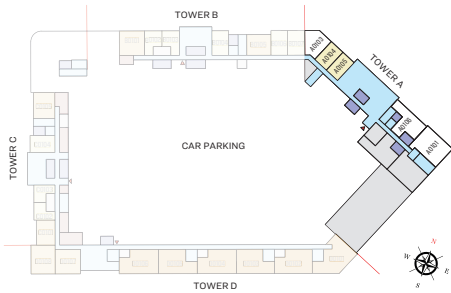

LEVEL 01 (PODIUM 01)

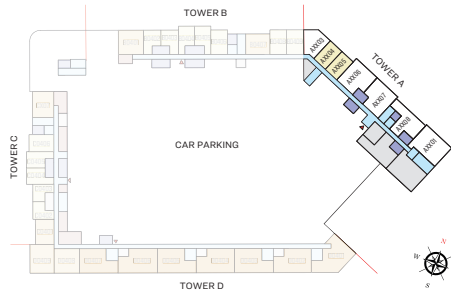

LEVEL 02-04

UNIT

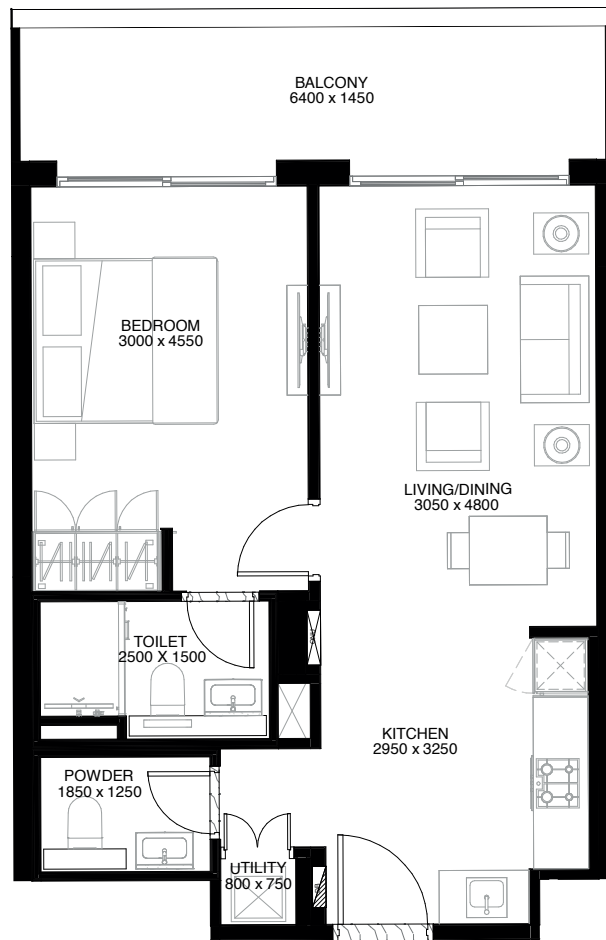

List of unit numbers with this unit plan:

VIEWS

Sports Court
 A0104, A0105

Downtown, Sports Court
 A0204, A0205, A0304, A0305, A0404, A0405

* These apartments have mirrored units plans of the above

1 BEDROOM APARTMENT

TYPE C (with powder room + balcony)

TOTAL SALEABLE AREA

SUITE = 634.75 SQ.FT.
 BALCONY = 48.76 SQ.FT.
 TOTAL = 683.51 SQ.FT.

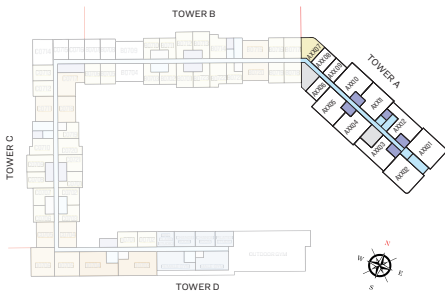

LEVEL 07-16

UNIT

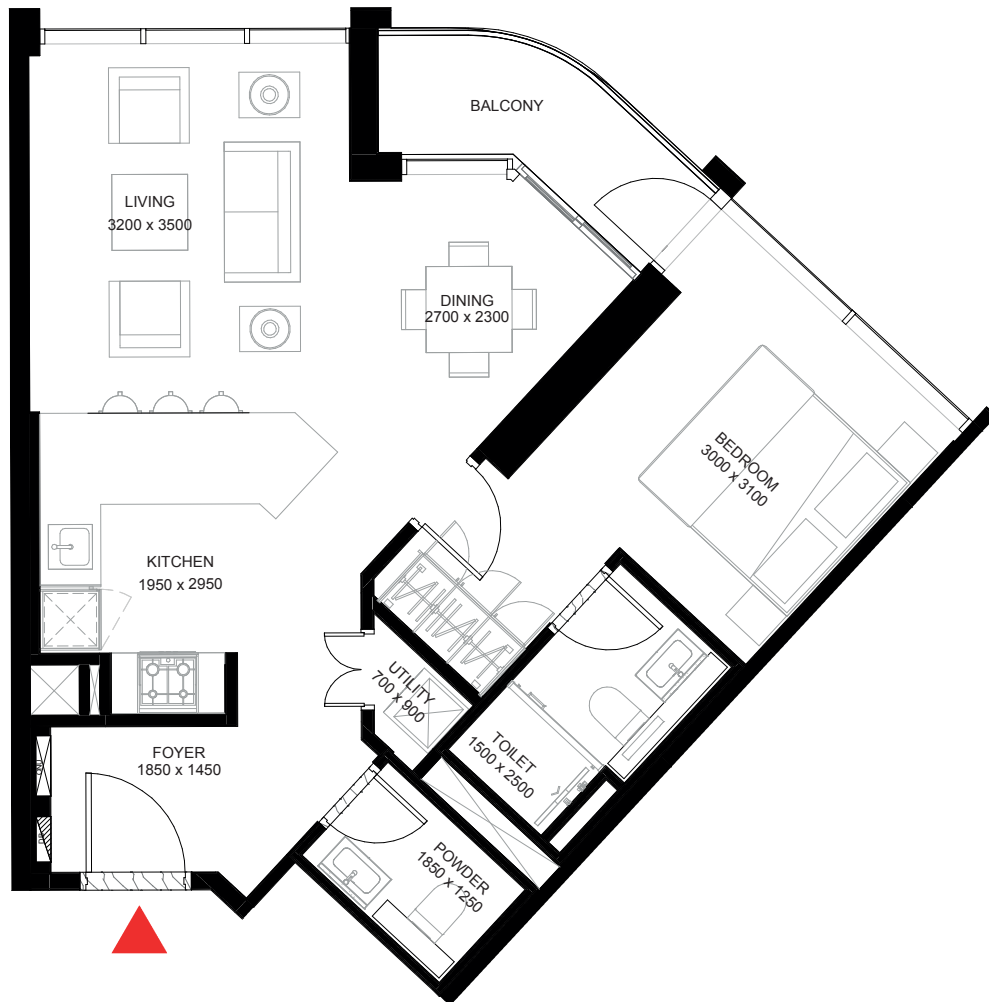

List of unit numbers with this unit plan:

VIEWS

Downtown, Sports Court, Ras Al Khor
 A0707, A0807, A0907, A1007, A1107, A1207, A1307, A1407, A1507, A1607

* These apartments have mirrored units plans of the above

1 BEDROOM APARTMENT

TYPE C1 (with powder room + balcony)

TOTAL SALEABLE AREA

SUITE = 673.58 SQ.FT.
 BALCONY = 215.86 SQ.FT.
 TOTAL = 889.44 SQ.FT.

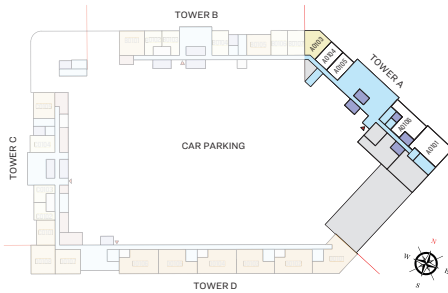

LEVEL 01

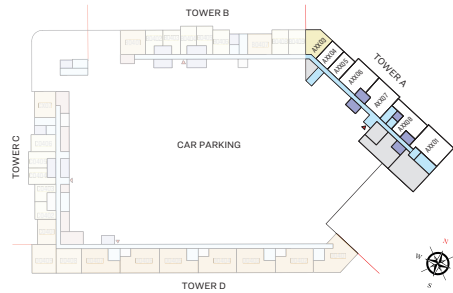

LEVEL 02-04

 UNIT

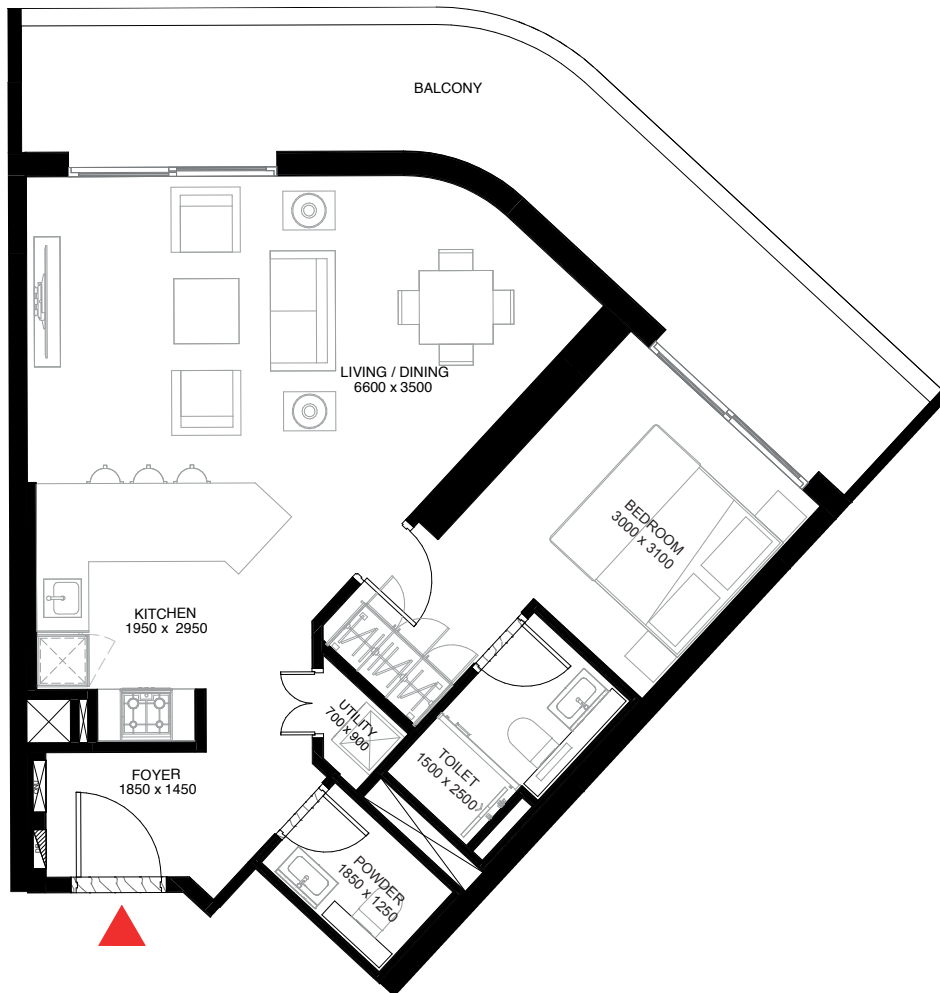

List of unit numbers with this unit plan:

VIEWS

Sports Court
 A0103

Downtown, Sports Court
 A0203, A0303, A0403

* These apartments have mirrored units plans of the above

2 BEDROOM APARTMENT TYPE C (with maid room + balcony)

TOTAL SALEABLE AREA

SUITE = 1209.86 SQ.FT.
BALCONY = 60.82 SQ.FT.
TOTAL = 1270.68 SQ.FT.

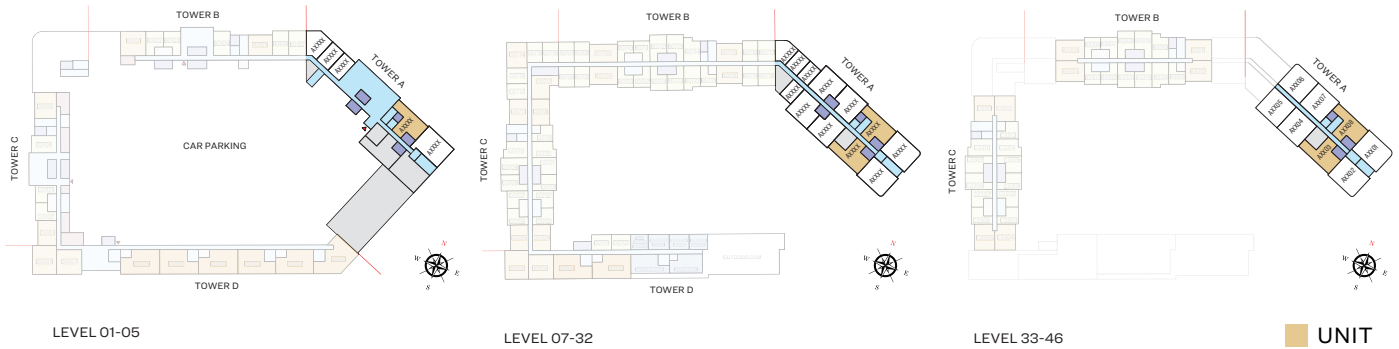

List of unit numbers with this unit plan:

VIEWS

Sports Court
A0106*

Downtown, Sports Court
A0208*, A0308*, A0408*, A0505*

Downtown, Sports Court, Ras Al Khor
A0712*, A0812*, A0912*, A1012*, A1112*, A1212*, A1312*, A1412*, A1512*, A1612*, A1709*, A1809*, A1909*, A2009*, A2109*, A2209, A2309*, A2409*, A2508*, A2604*, A2704*, A3106*, A3206*, A3308*, A3408*, A3508*, A3608*, A3708*, A3808*, A3908*, A4008*, A4108*, A4208*, A4308*, A4408*, A4508*, A4608*

Amenities, Waterfront

A0703, A0803, A0903, A1003, A1103, A1203, A1303, A1403, A1503, A1603, A1703, A1803, A1903, A2003, A2103, A2203, A2303, A2403, A2503, A2603, A2703, A3101, A3201, A3303, A3403, A3503, A3603, A3703, A3803, A3903, A4003, A4103

Amenities, Waterfront, Downtown

A4203, A4303, A4403, A4503, A4603

* These apartments have mirrored units plans of the above

2 BEDROOM APARTMENT

TYPE D (with maid room + balcony)

TOTAL SALEABLE AREA

SUITE = 1157.34 SQ.FT.
 BALCONY = 114.85 SQ.FT.
 TOTAL = 1272.19 SQ.FT.

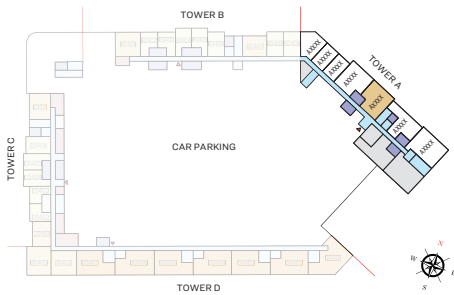

LEVEL 02-05

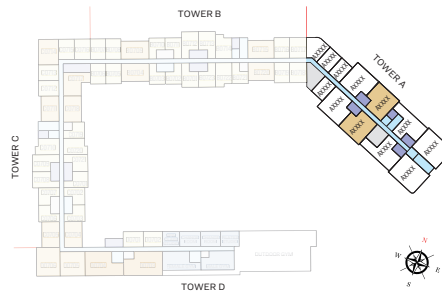

LEVEL 07-25

UNIT



List of unit numbers with this unit plan:

VIEWS

Amentites

A0704, A0804, A0904

Amenities, Waterfront

A1004, A1104, A1204, A1304, A1404, A1504, A1604, A1704, A1804, A1904, A2004, A2104, A2204, A2304, A2404, A2504

Downtown, Sports Court

A0207*, A0307*, A0407*, A0504*

Downtown, BK, Sports Court, Ras Al Khor

A0711*, A0811*, A0911*, A1011*, A1111*, A1211*, A1311*, A1411*, A1511*, A1611*, A1708*, A1808*, A1908*, A2008*, A2108*, A2208*, A2308*, A2408*, A2507*

* These apartments have mirrored units plans of the above

2 BEDROOM APARTMENT TYPE E (with maid room + balcony)

TOTAL SALEABLE AREA
 SUITE = 1170.36 SQ.FT.
 BALCONY = 118.30 SQ.FT.
 TOTAL = 1288.66 SQ.FT.

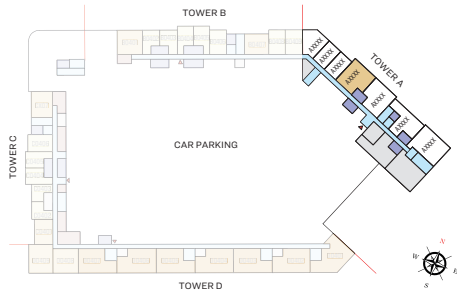

LEVEL 02-05

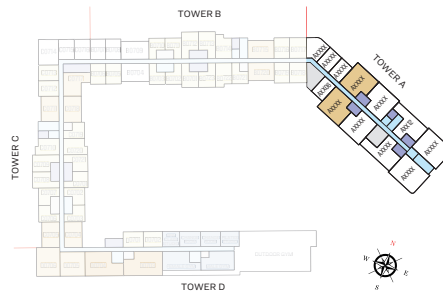

LEVEL 07-25

UNIT

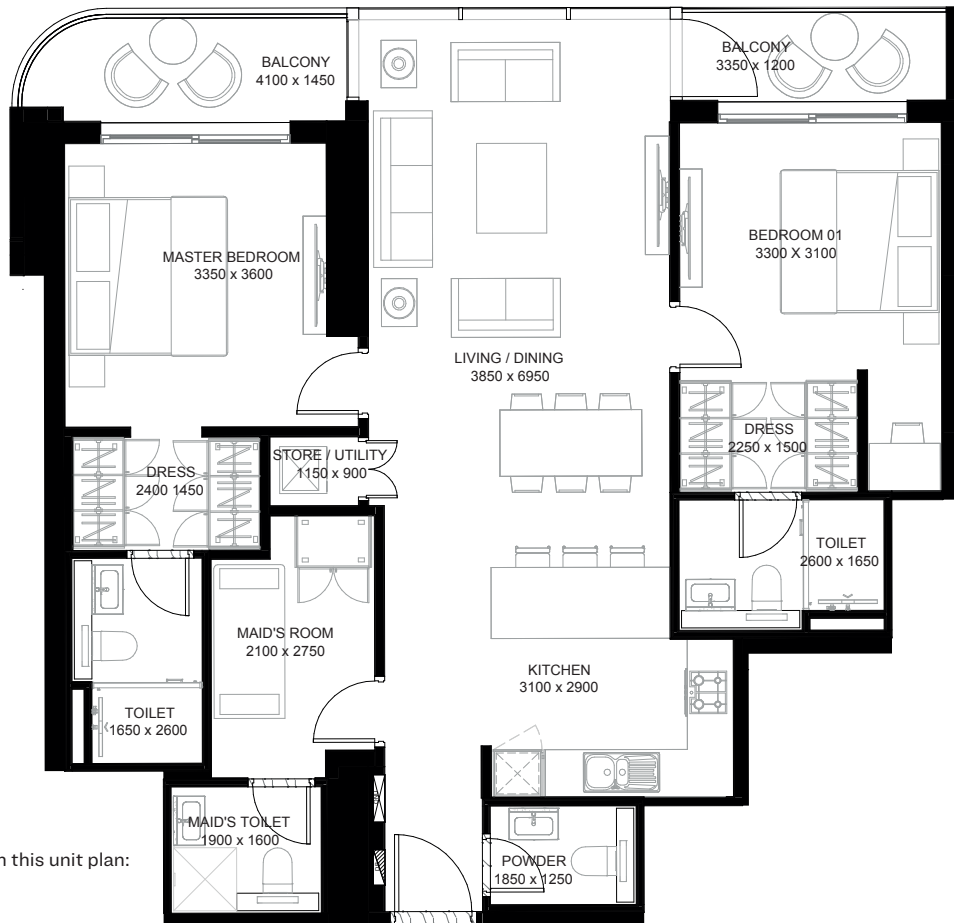

List of unit numbers with this unit plan:

VIEWS

Amenities

A0705, A0805, A0905

Amenities, Waterfront

A1005, A1105, A1205, A1305, A1405, A1505, A1605, A1705, A1805, A1905, A2005, A2105, A2205, A2305, A2405, A2505

Downtown, Sports Court

A0206*, A0306*, A0406*, A0503*

Downtown, Sports Court, Ras Al Khor

A0710*, A0810*, A0910*, A1010*, A1110*, A1210*, A1310*, A1410*, A1510*, A1610*, A1707*, A1807*, A1907*, A2007*, A2107*, A2207*, A2307*, A2407*, A2506*

* These apartments have mirrored units plans of the above

2 BEDROOM APARTMENT

TYPE F (with maid room + balcony)

TOTAL SALEABLE AREA

SUITE = 1279.51 SQ.FT.

BALCONY = 114.74 SQ.FT.

TOTAL = 1394.25 SQ.FT.

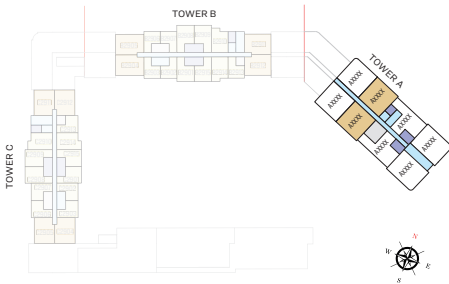

LEVEL 29-46

UNIT



List of unit numbers with this unit plan:

VIEWS

Amenities, Waterfront

A2901, A3001, A3102, A3202, A3304, A3404, A3504, A3604, A3704, A3804, A3904, A4004, A4104

Amenities, Waterfront, Downtown

A4204, A4304, A4404, A4504, A4604

Downtown, Sports Court, Ras Al Khor

A2904*, A3004*, A3105*, A3205*, A3307*, A3407*, A3507*, A3607*, A3707*, A3807*, A3907*, A4007*, A4107*, A4207*, A4307*, A4407*, A4507*, A4607*

* These apartments have mirrored units plans of the above

2 BEDROOM APARTMENT

TYPE G (with maid room + balcony)

TOTAL SALEABLE AREA

SUITE = 1270.25 SQ.FT.

BALCONY = 116.57 SQ.FT.

TOTAL = 1386.82 SQ.FT.

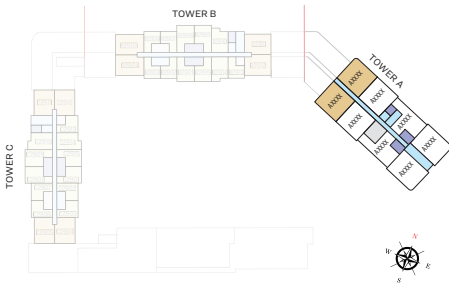

LEVEL 29-46

 UNIT



List of unit numbers with this unit plan:

VIEWS

Downtown, Sports Court, Ras Al Khor

A2903*, A3003*, A3104*, A3204*, A3306*, A3406*, A3506*, A3606*, A3706*, A3806*, A3906*, A4006*, A4106*, A4206*, A4306*, A4406*, A4506*, A4606*

Amenities, Waterfront, Downtown

A2902, A3002, A3103, A3203, A3305, A3405, A3505, A3605, A3705, A3805, A3905, A4005, A4105, A4205, A4305, A4405, A4505, A4605

* These apartments have mirrored units plans of the above

3 BEDROOM APARTMENT

TYPE B (with maid room + balcony)

TOTAL SALEABLE AREA

SUITE = 1497.15 SQ.FT.
 BALCONY = 68.24 SQ.FT.
 TOTAL = 1565.40 SQ.FT.

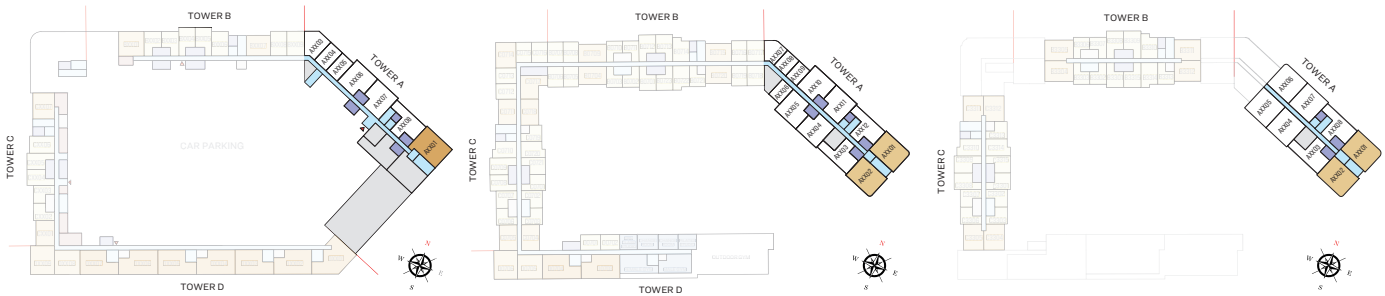

LEVEL 01-05

LEVEL 07-28

LEVEL 33-46

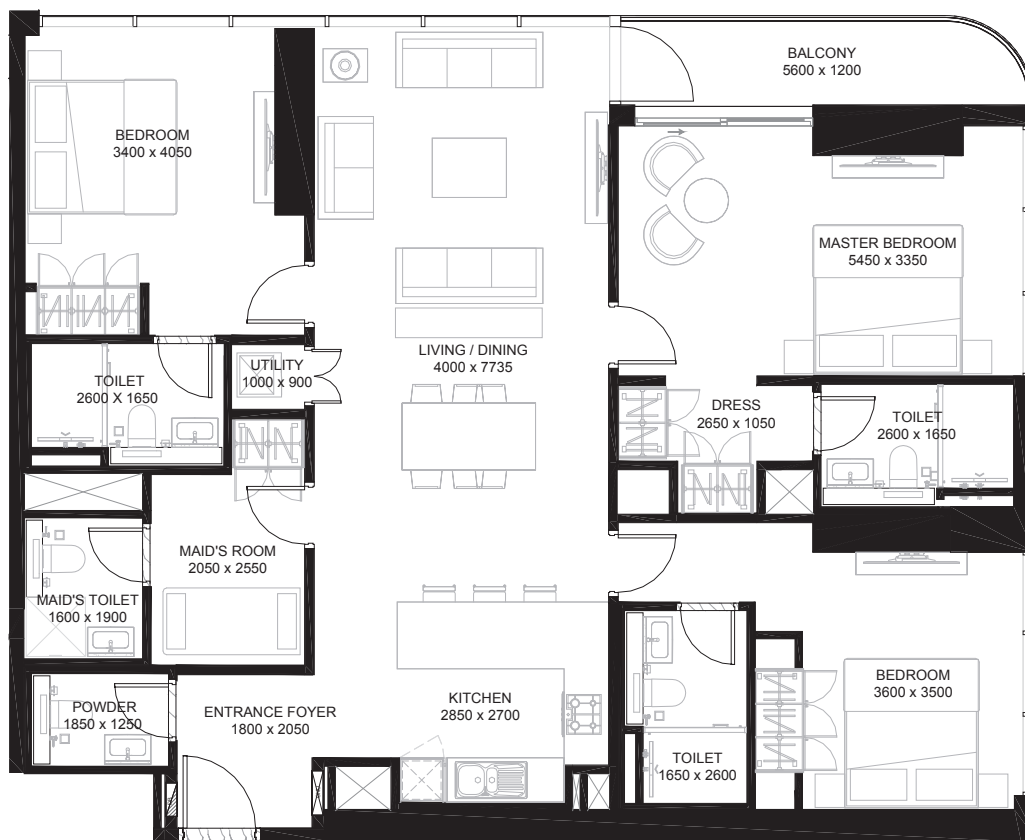

List of unit numbers with this unit plan:

VIEWS

Amenities, Waterfront

A0702*, A0802*, A0902*, A1002*, A1102*, A1202*, A1302*, A1402*, A1502*, A1602*, A1702*, A1802*, A1902*, A2002*, A2102*, A2202*, A2302*, A2402*, A2502*, A2602*, A2702*, A2802*, A3302*, A3402*, A3502*, A3602*, A3702*, A3802*, A3902*, A4002*, A4102*

Amenities, Waterfront, Downtown

A4202*, A4302*, A4402*, A4502*, A4602*

Sports Court

A0101

Downtown, Sports Court

A0201, A0301, A0401, A0501

Downtown, Sports Court, Ras Al Khor

A0701, A0801, A0901, A1001, A1101, A1201, A1301, A1401, A1501, A1601, A1701, A1801, A1901, A2001, A2101, A2201, A2301, A2401, A2501, A2601, A2701, A2801, A3301, A3401, A3501, A3601, A3701, A3801, A3901, A4001, A4101, A4201, A4301, A4401, A4501, A4601

* These apartments have mirrored units plans of the above

SOBHA
REALTY